



---

Vehicle	ALFA ROMEO / Alfa 147 1.9 JTD / 11/2000 - 03/2005 / Лимузина стръмен наклон отзад
Country of manufacture	I
Cubic capacity/Power	1.9 / 81 - 85 kW
Motor tag	937A2000
RB key	ALF 405

---

## Known fixes and bulletins

### Bulletin

- Driveability
- Engine management
- Engine mechanical
- Exhaust
- Fuel system
- Noise, vibration and harshness

## Affected vehicles

- All models with 1,9D JTD 8V/16V/2,4D JTD 20V engines.

## Problem

- Engine jerking.
- Hesitation when accelerating at 1800-2000 rpm.

## Cause

- Exhaust gas recirculation (EGR) valve not operating properly.

## Remedy

Parts			
Description	Part number	Engine	Quantity
Restrictor plate	71751468	1,9D JTD 16V/2,4D JTD 20V	1
Gasket	55191883	1,9D JTD 16V/2,4D JTD 20V	2
Restrictor plate	71751468	1,9D JTD 8V	1
Gasket	55191883	1,9D JTD 8V	2

- Check operation of thermostat.
- Check engine oil level correct.
- Check for contamination of fuel.
- Check fuel filter.
- Check whole intake system for leaks.
- Check mass air flow (MAF) sensor.
- Check for oil in intake system.

- Check fuel injectors for leaks.
- Check fuel injectors for correct type.
- Ensure EGR system operates correctly.
- Remove EGR valve and fit restrictor plate:
  - 1,9D JTD 16V/2,4D JTD 20V Fig.1.
  - 1,9D JTD 8V Fig.2.

Fig.114235 Fig.114239

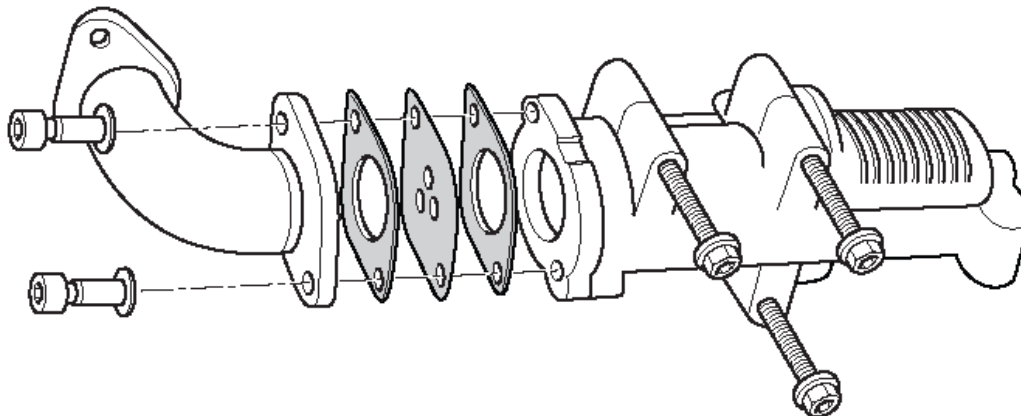
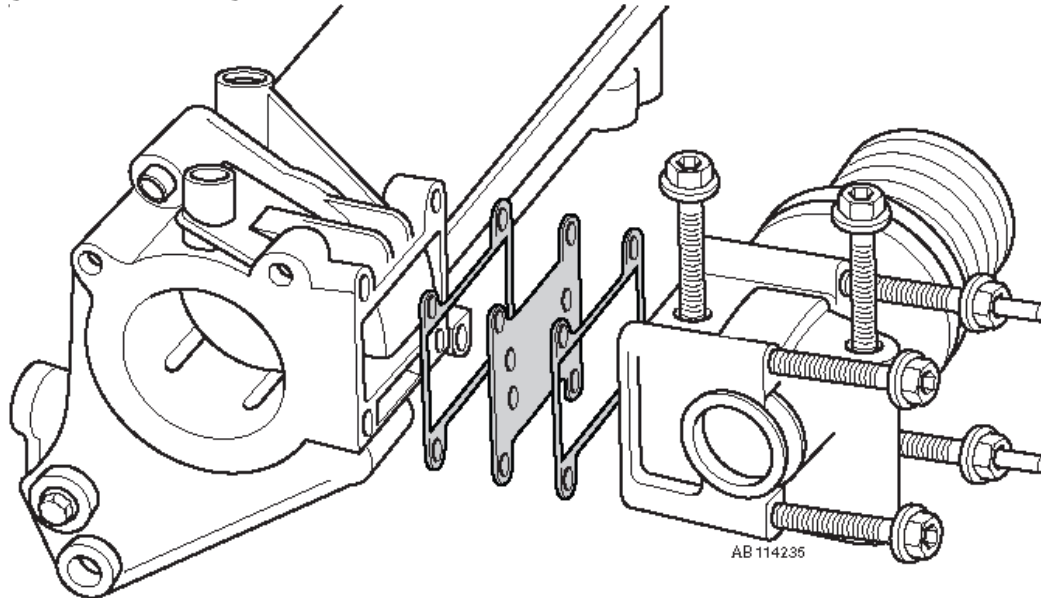

AB114239